



GMR Engineering Services

PRELIMINARY  
(NOT FOR CONSTRUCTION)  
20/10/2015

# Goulburn Broken Catchment Management Authority

## Lower Goulburn Structures Evaluations

### Goulburn River, Bunbartha & Kotupna

LOCALITY PLAN

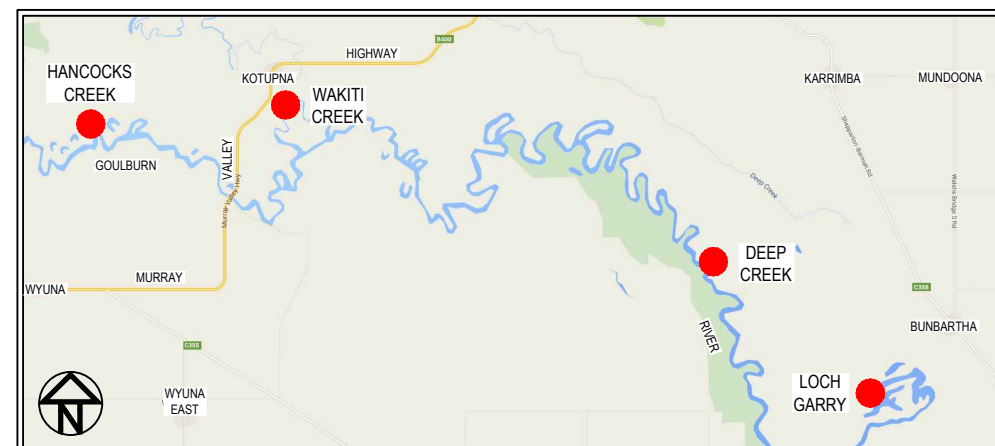

GOULBURN  
BROKEN  
CATCHMENT  
MANAGEMENT  
AUTHORITY

DRAWING SCHEDULE

DRAWING No.	DRAWING TITLE	REVISION
GMR15013.01	COVER SHEET, LOCALITY PLAN, DRAWING SCHEDULE	1
GMR15013.02-03	LOCH GARRY - EXISTING CONDITIONS ARRANGEMENTS	1
GMR15013.04	DEEP CREEK - EXISTING CONDITIONS ARRANGEMENTS	1
GMR15013.05	WAKITI CREEK - EXISTING CONDITIONS ARRANGEMENTS	1
GMR15013.06	HANCOCKS CREEK - EXISTING CONDITIONS ARRANGEMENTS	1
GMR15013.07-08	LOCH GARRY - WORKS ARRANGEMENTS	2
GMR15013.09	DEEP CREEK - WORKS ARRANGEMENTS	2
GMR15013.10	WAKITI CREEK - WORKS ARRANGEMENTS	2
GMR15013.11	HANCOCKS CREEK - WORKS ARRANGEMENTS	2

THIS DOCUMENT IS COPYRIGHT PROTECTED AND MAY ONLY  
BE USED FOR THE PURPOSE FOR WHICH IT WAS INTENDED.  
UNAUTHORISED USE IS STRICTLY PROHIBITED. ALL  
DIMENSIONS AND LEVELS TO BE CHECKED ON THE PROJECT  
BEFORE COMMENCING ANY WORKS OR SHOP DRAWINGS.  
DRAWINGS NOT TO BE SCALED.



**WARNING**  
**BEWARE OF UNDERGROUND SERVICES**  
The locations of underground services are  
approximate only and their exact position  
should be proven on site. No guarantee is  
given that all existing services are shown.

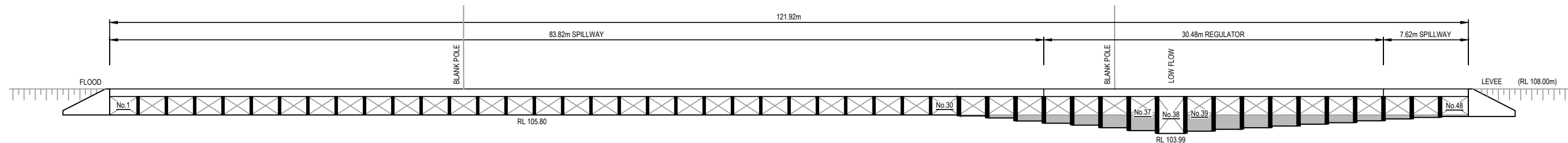

### LOCH GARRY LONGITUDINAL SECTION

SCALE 1:200 @ A1  
SCALE 1:400 @ A1

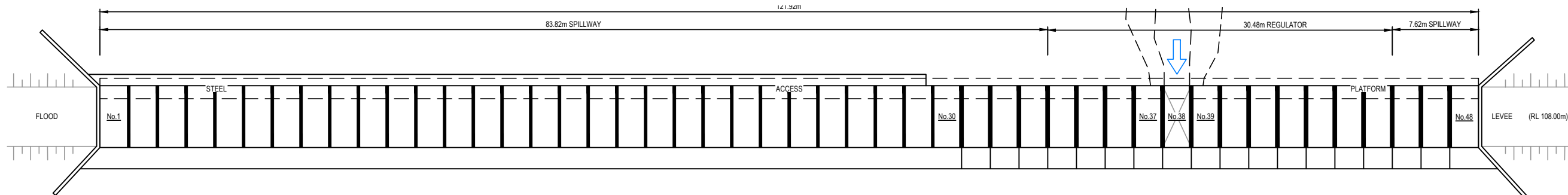

### LOCH GARRY OVERALL PLAN

SCALE 1:200 @ A1  
SCALE 1:400 @ A1



SITE PHOTO. LOOKING EAST ON DOWN STREAM SIDE OF LOCH GARRY



SITE PHOTO. LOOKING SOUTH ON UPSTREAM SIDE OF LOCH GARRY



SITE PHOTO. LOOKING NORTH ON DOWN STREAM SIDE OF LOCH GARRY

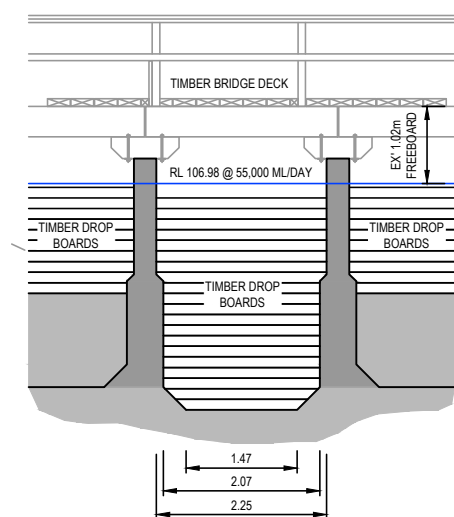

### LOCH GARRY INVERT REGULATOR BAY 38 (LOW FLOW)

#### SECTION B - B

SCALE 1:50 @ A1  
SCALE 1:100 @ A1

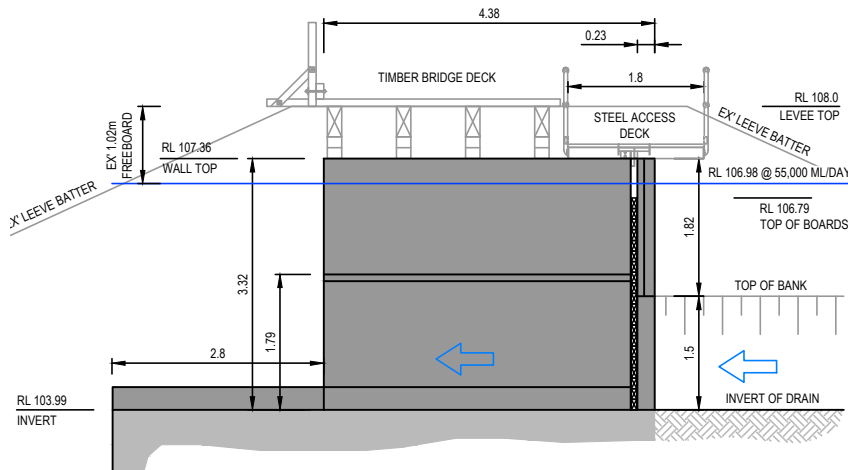

### LOCH GARRY INVERT REGULATOR BAY 38 (LOW FLOW)

#### SECTION A - A

SCALE 1:50 @ A1  
SCALE 1:100 @ A1

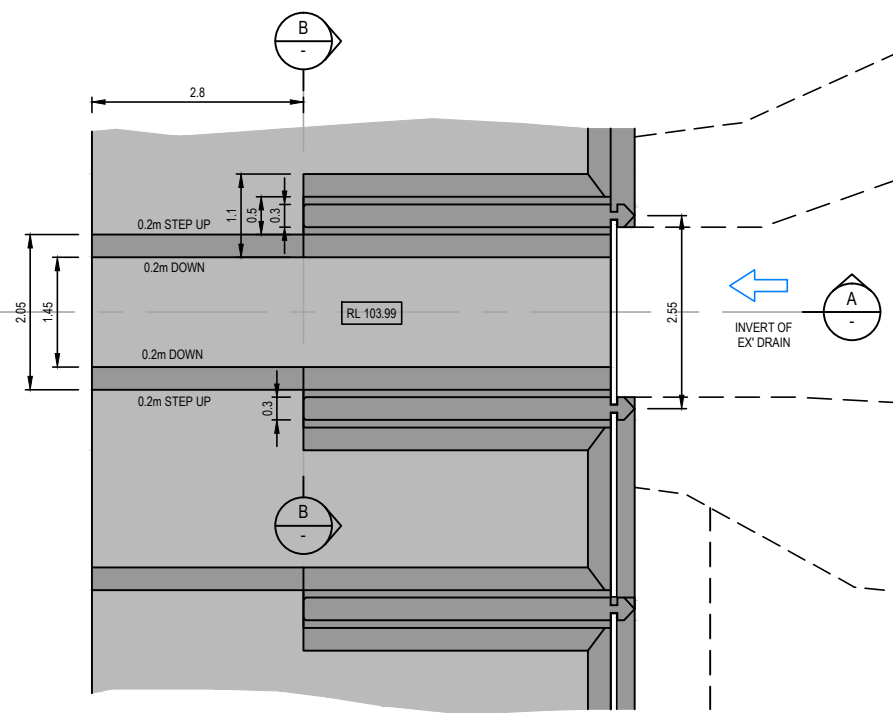

### LOCH GARRY INVERT REGULATOR BAY 38 (LOW FLOW)

#### PLAN

SCALE 1:50 @ A1  
SCALE 1:100 @ A1



Phone: (03) 5822 0333  
Fax: (03) 5822 0033  
Website: gmreng.com.au

**WARNING**  
**BEWARE OF UNDERGROUND SERVICES**  
The locations of underground services are approximate only and their exact position should be proven on site. No guarantee is given that all existing services are shown.

**NOTE !**  
**BEWARE OF EXISTING OVERHEAD POWER CABLES.**

**PRELIMINARY**  
**(NOT FOR CONSTRUCTION)**  
**20/10/2015**

**REDUCED SCALE**



DESIGNED: R. Barker  
DRAFTED: September 2015  
VERIFIED:

REV	AMENDMENTS	DATE
1	GENERAL AMENDMENTS	28-09-15
A	INITIAL DRAFT	18-09-15
REV	AMENDMENTS	DATE

0 0.5 1 2.0m  
SCALE 1:50 @ A1  
SCALE 1:100 @ A3



### GMR Engineering Services

Goulburn Broken Catchment Management Authority  
Lower Goulburn Structure Evaluation  
Loch West Road, Bunbartha

Existing Conditions - Loch Garry 1 of 2

Drawing No. GMR15013.02

Revision. A  
GMR15013.03 existing conditions.dwg

Sheet No. 2

A1





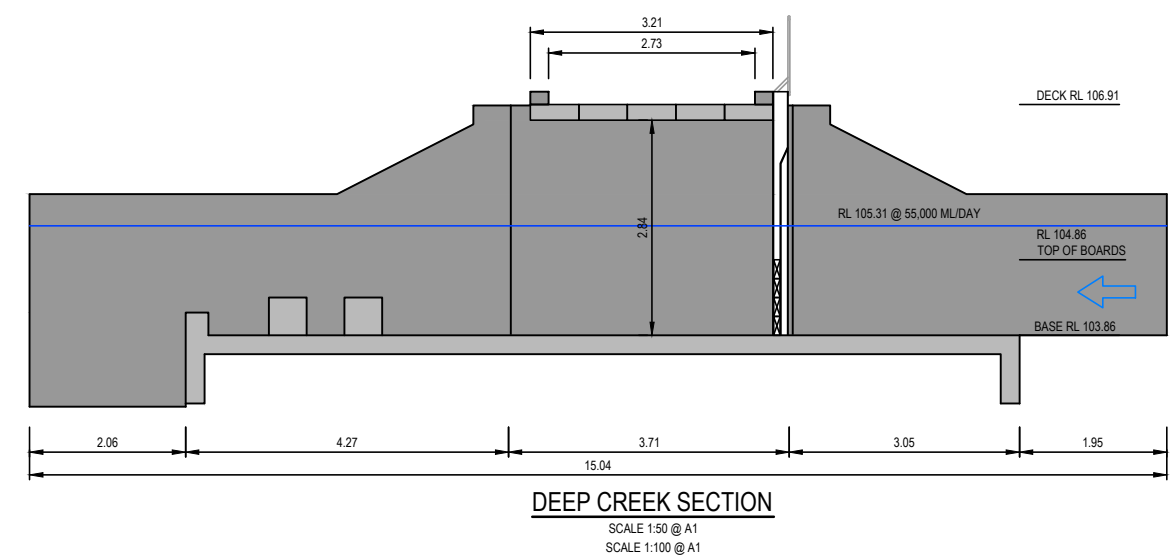
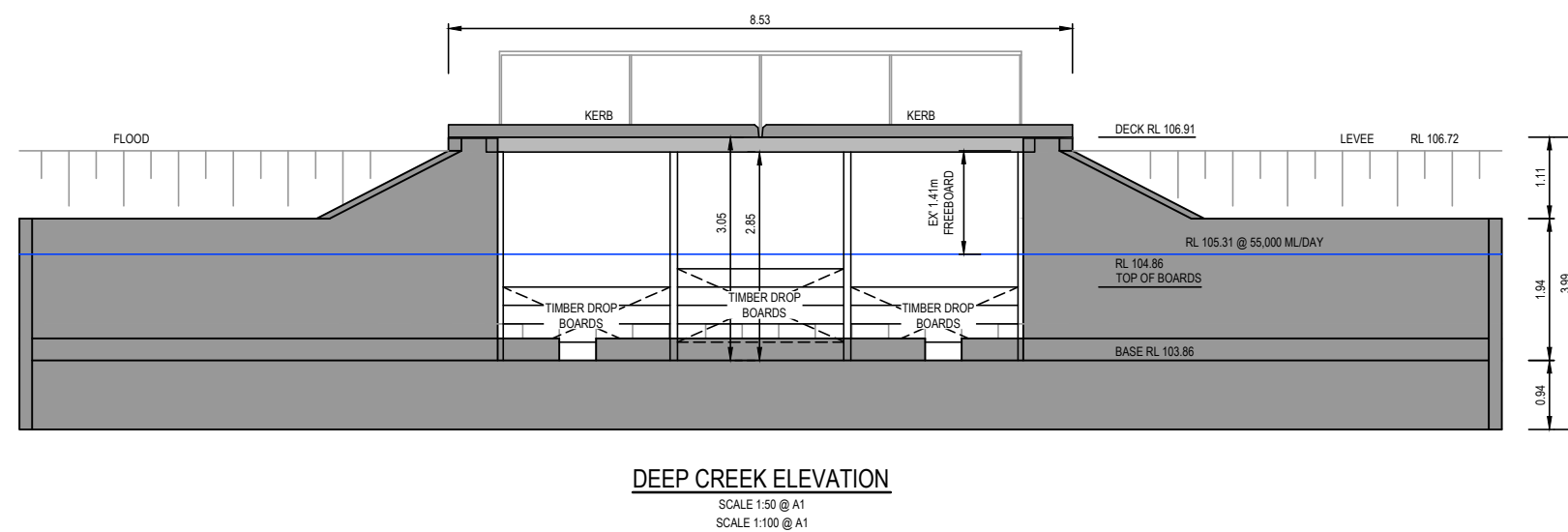
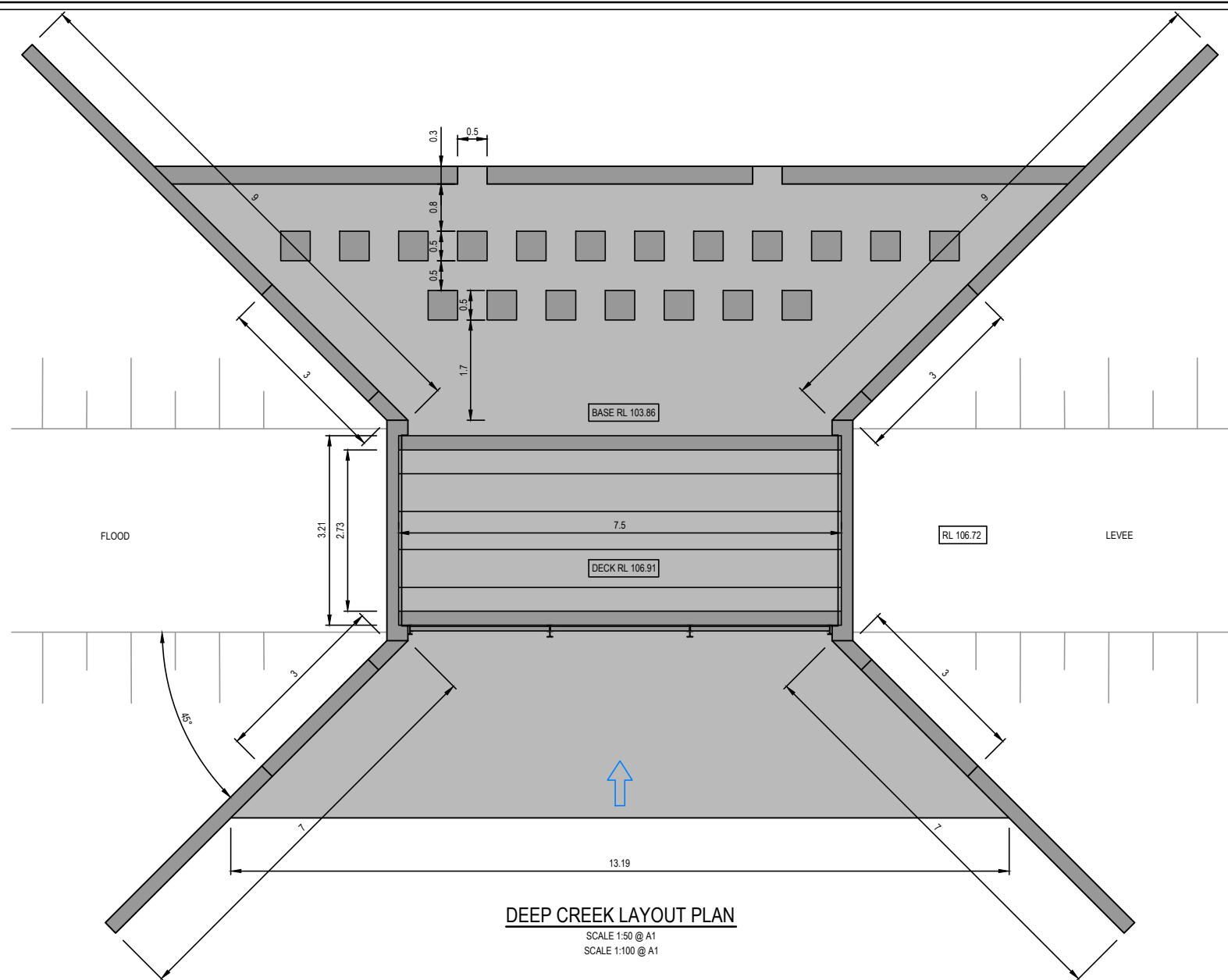



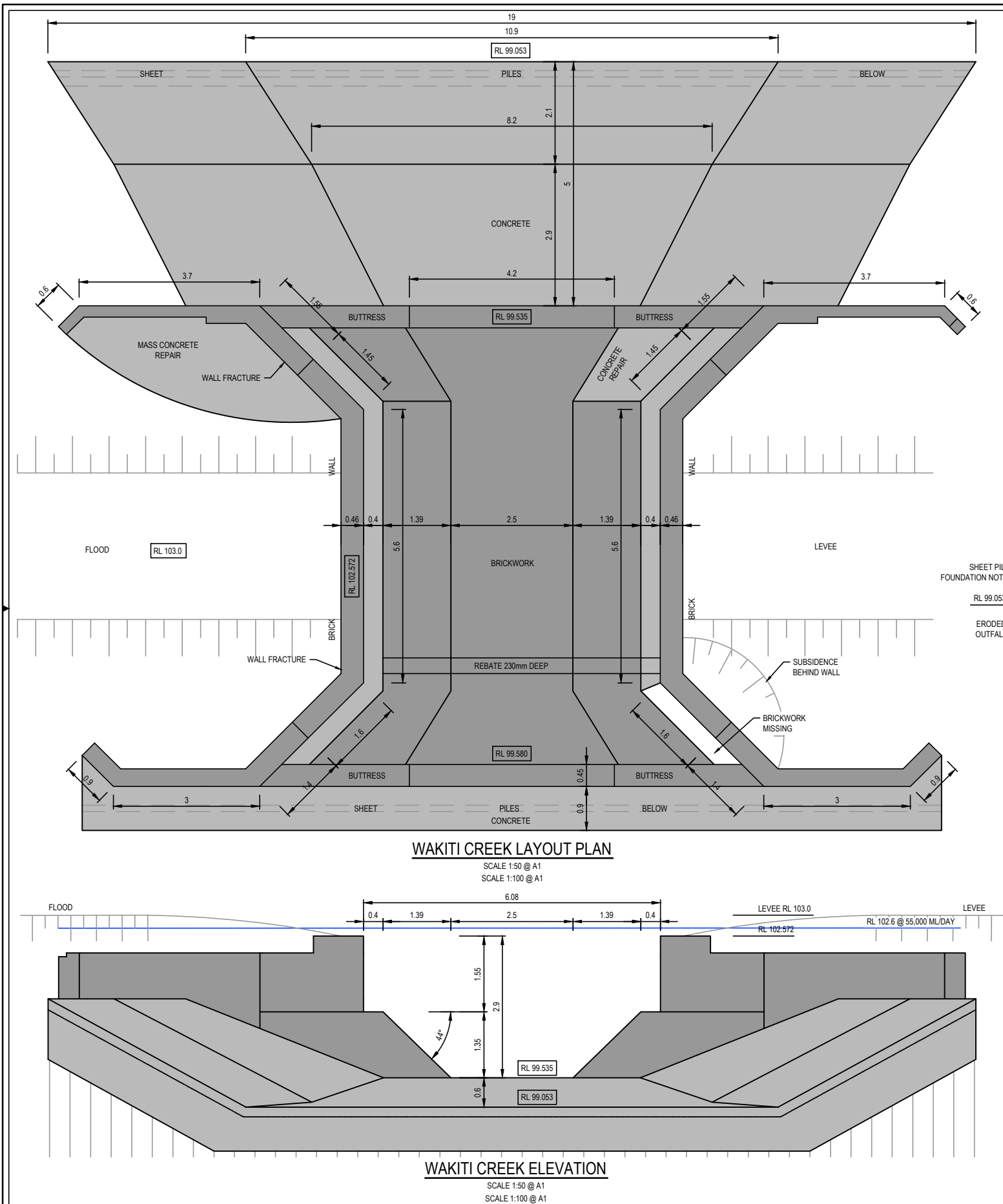

SITE PHOTO. LOOKING SOUTH ON DOWN STREAM SIDE OF WAKITI CREEK OUTLET STRUCTURE

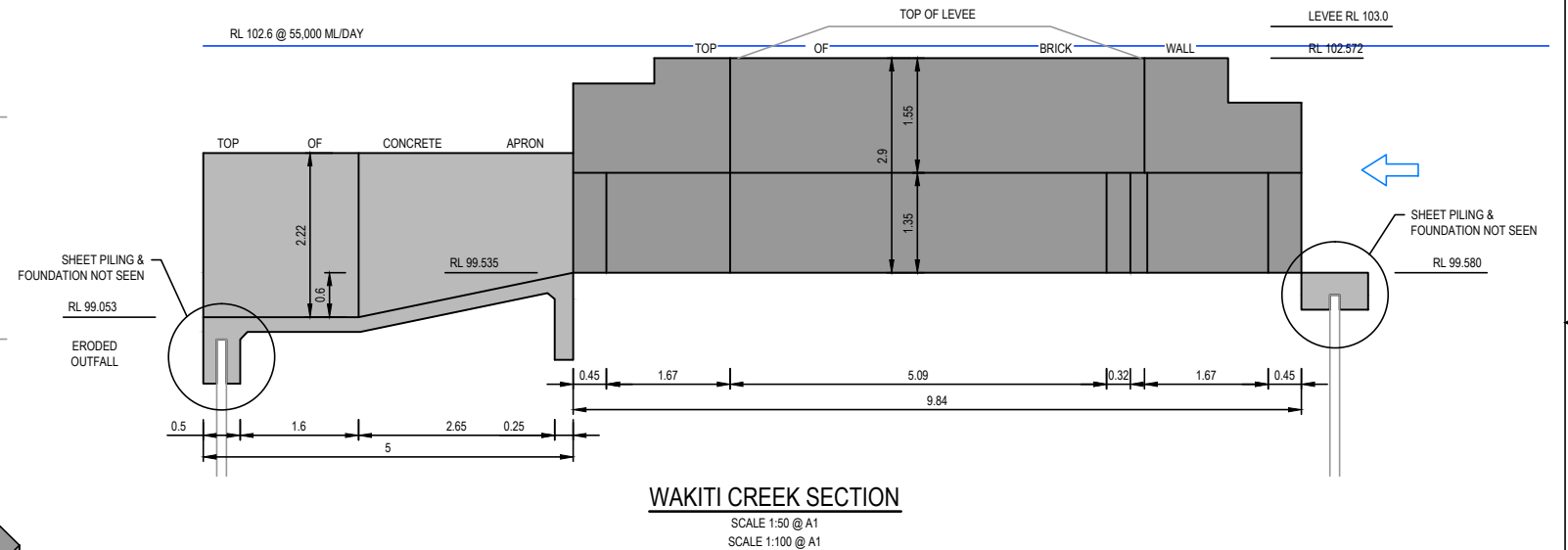

SITE PHOTO. LOOKING SOUTH EAST ON DOWN STREAM SIDE OF WAKITI CREEK OUTLET STRUCTURE



SITE PHOTO. LOOKING NORTH ON UPSTREAM SIDE OF WAKITI CREEK OUTLET STRUCTURE





SITE PHOTO. LOOKING SOUTH ALONG LEVEE @ HANCOCKS CREEK OUTLET STRUCTURE



SITE PHOTO. LOOKING NORTH UP STREAM SIDE OF HANCOCKS CREEK OUTLET STRUCTURE



SITE PHOTO. LOOKING WEST DOWN STREAM SIDE OF HANCOCKS CREEK OUTLET STRUCTURE

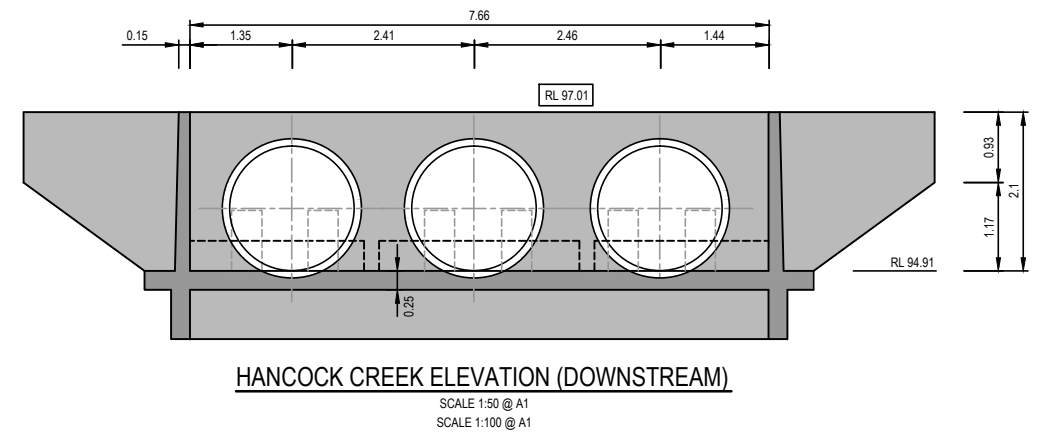
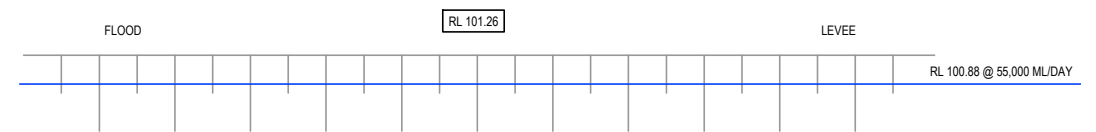
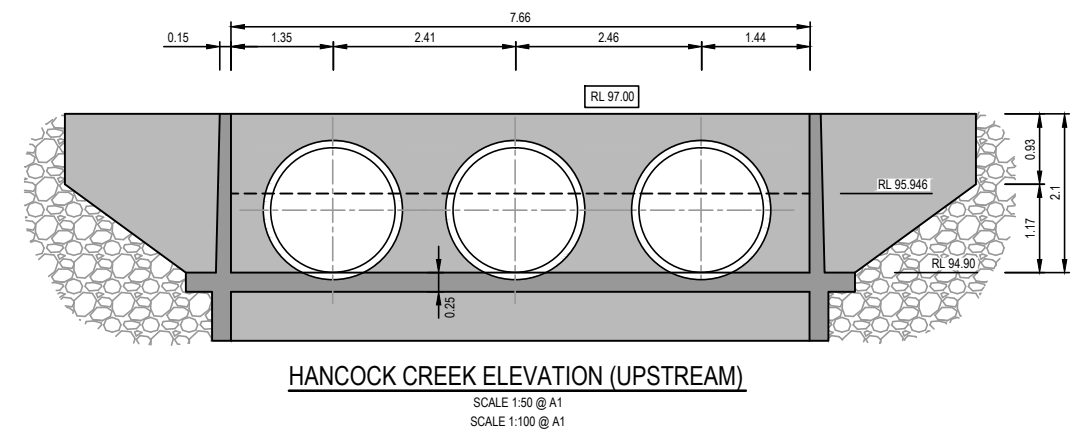
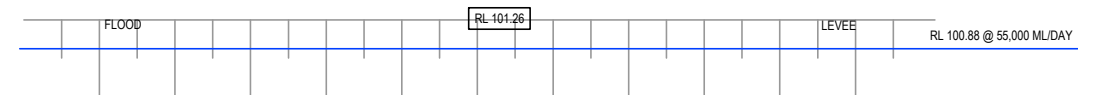
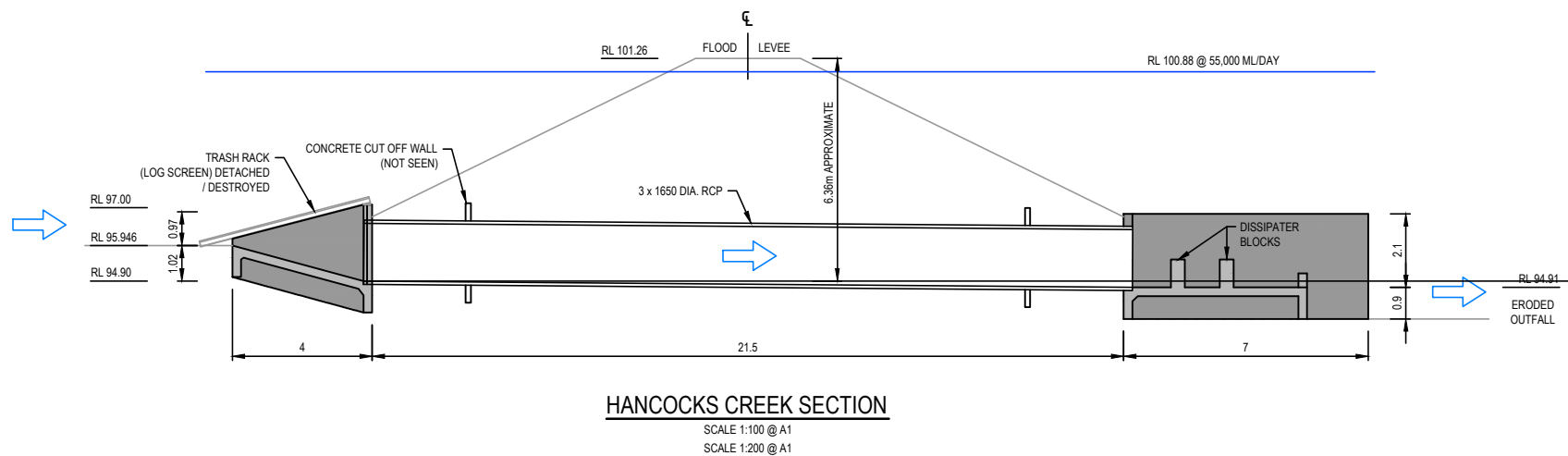
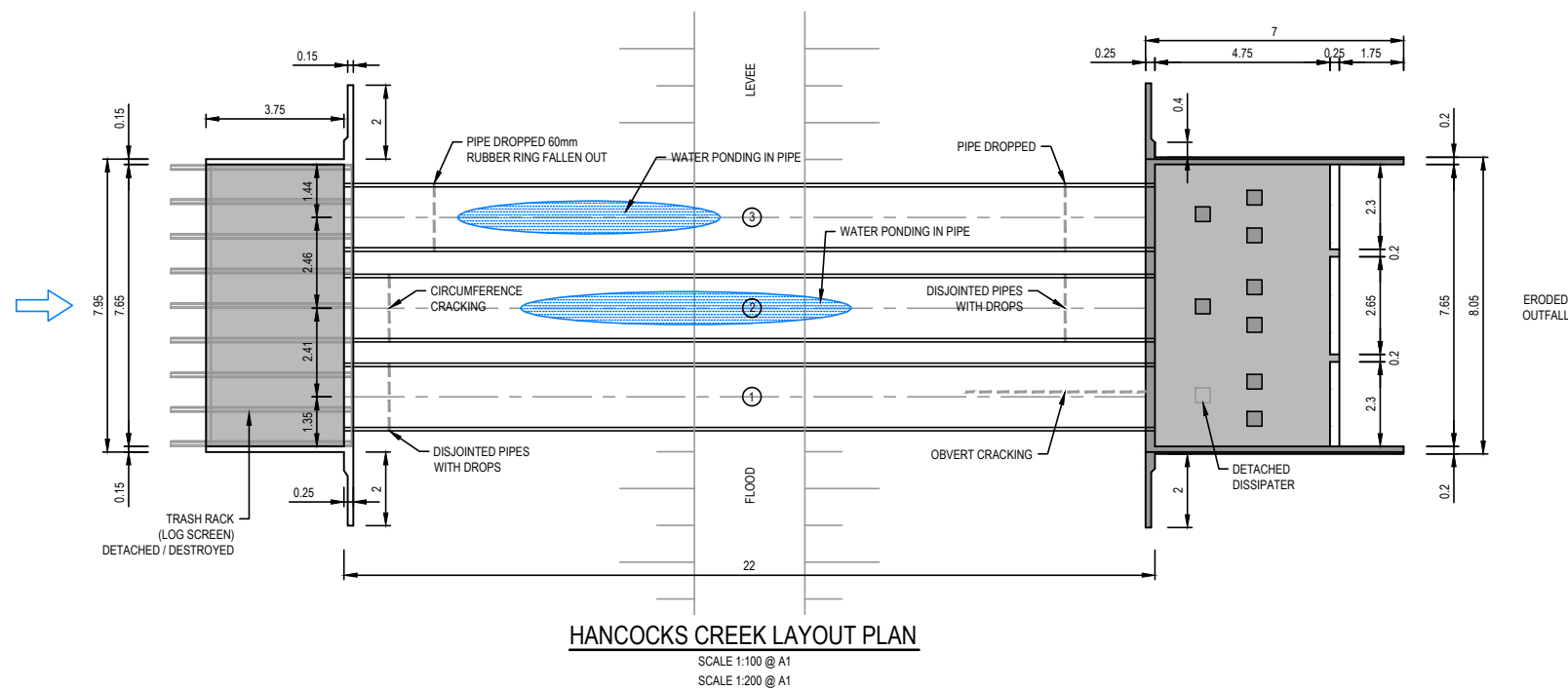

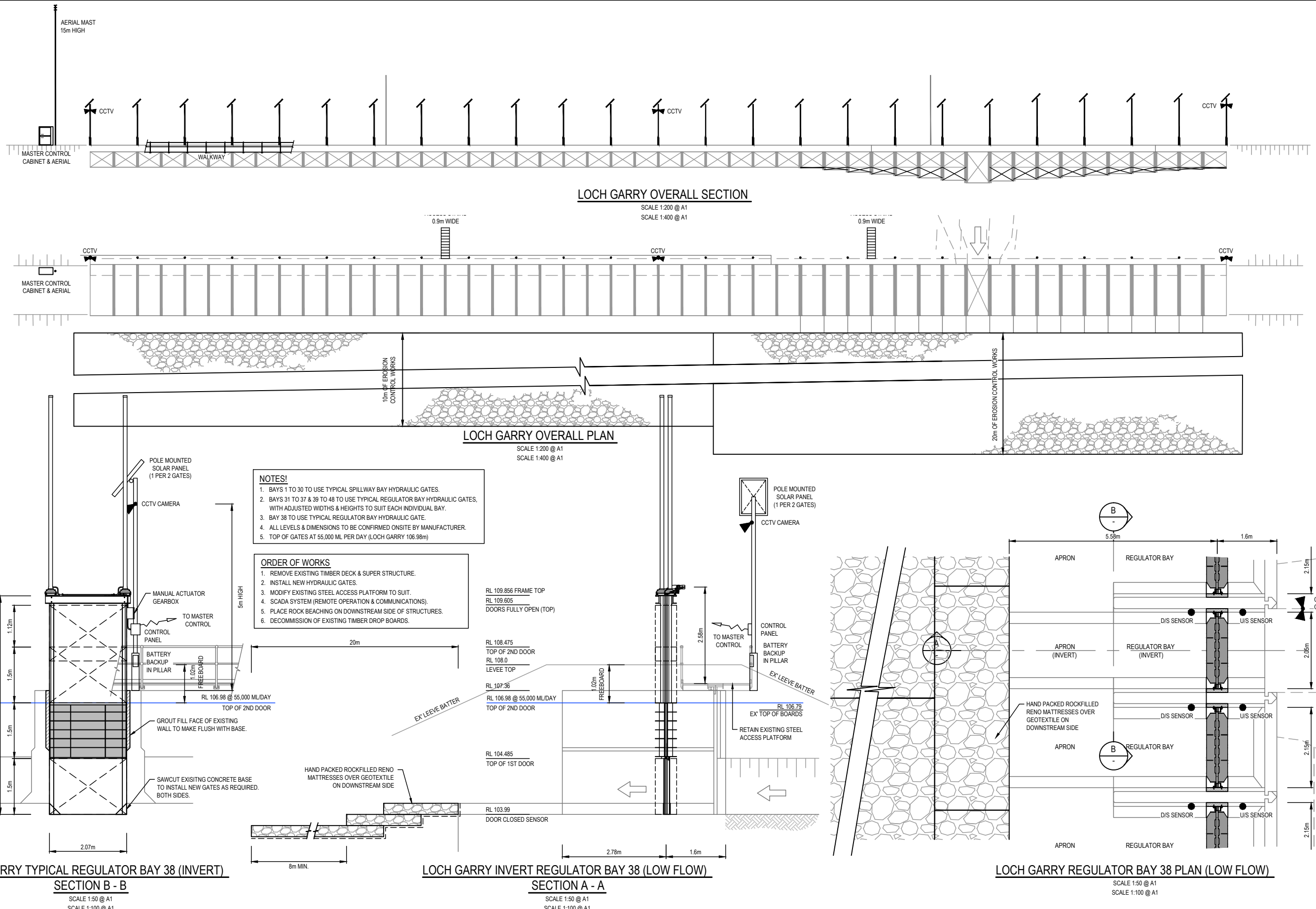

© GMR Engineering Services  
UNAUTHORISED USE IS STRICTLY PROHIBITED. ALL INFORMATION IS TO BE USED FOR THE PURPOSES FOR WHICH IT WAS INTENDED. BEFORE COMMENCING ANY WORKS OR SHOP DRAWINGS, DRAWINGS NOT TO BE SCALED.

**GMR Engineering Services**

Phone: (03) 5822 0333  
Fax: (03) 5822 0033  
Website: gmreng.com.au

**WARNING**  
BEWARE OF UNDERGROUND SERVICES  
The locations of underground services are approximate only and their exact position should be proven on site. No guarantee is given that all existing services are shown.

**NOTE !**  
BEWARE OF EXISTING OVERHEAD POWER CABLES.

**PRELIMINARY**  
(NOT FOR CONSTRUCTION)  
20/10/2015

**REDUCED SCALE**

**GOULBURN BROKEN CATCHMENT MANAGEMENT AUTHORITY**

DESIGNED	G. Ryan	September 2015
DRAFTED	R. Barker	September 2015
VERIFIED	C. S. Jajal	October 2015
2	GMR MARKUPS	25-09-15
1	ADOPTED 300mm FREEBOARD FROM LEVEE TOP	25-09-15
A	INITIAL DRAFT	18-09-15
REV	AMENDMENTS	DATE

0 0.5 1 2.0m  
SCALE 1:50 @ A1  
SCALE 1:100 @ A3

**North Arrow**

**GMR Engineering Services**  
Goulburn Broken Catchment Management Authority  
Lower Goulburn Structure Evaluation  
Loch West Road, Bunbartha

**Works Arrangements - Loch Garry**  
Drawing No. GMR15013.07  
Revision. 2  
GMR15013.04 proposed works.dwg

Sheet No. 7

A1



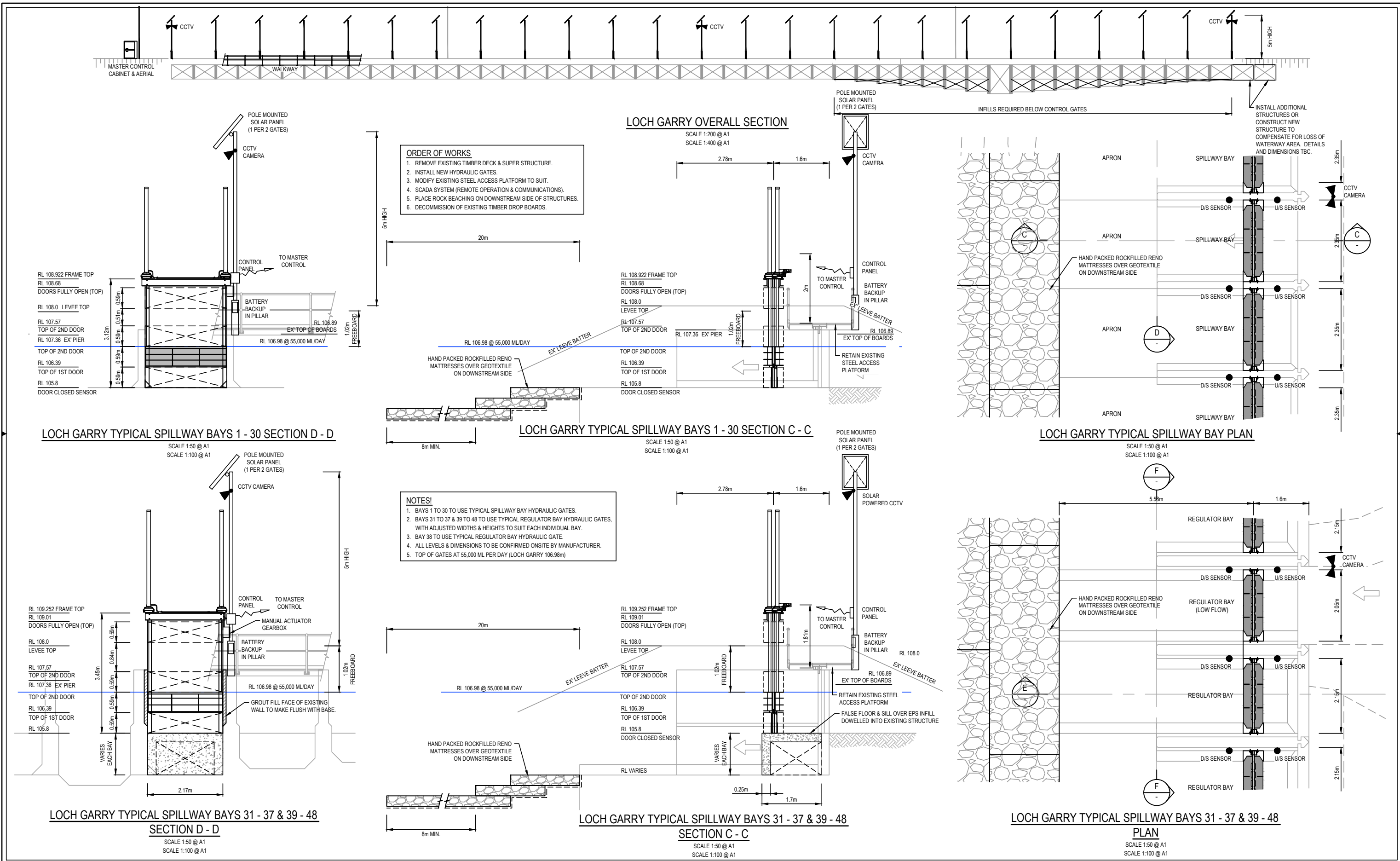



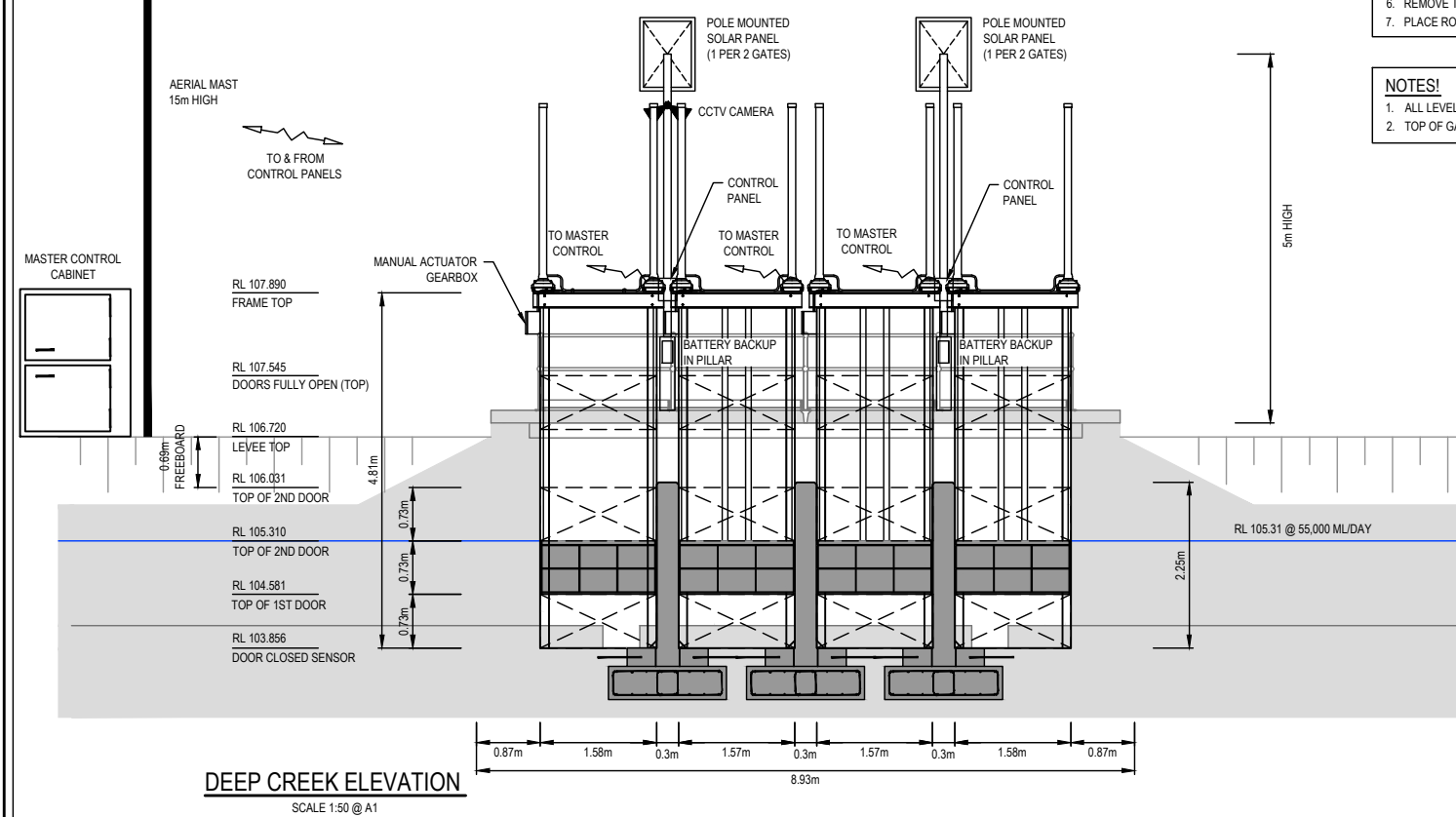
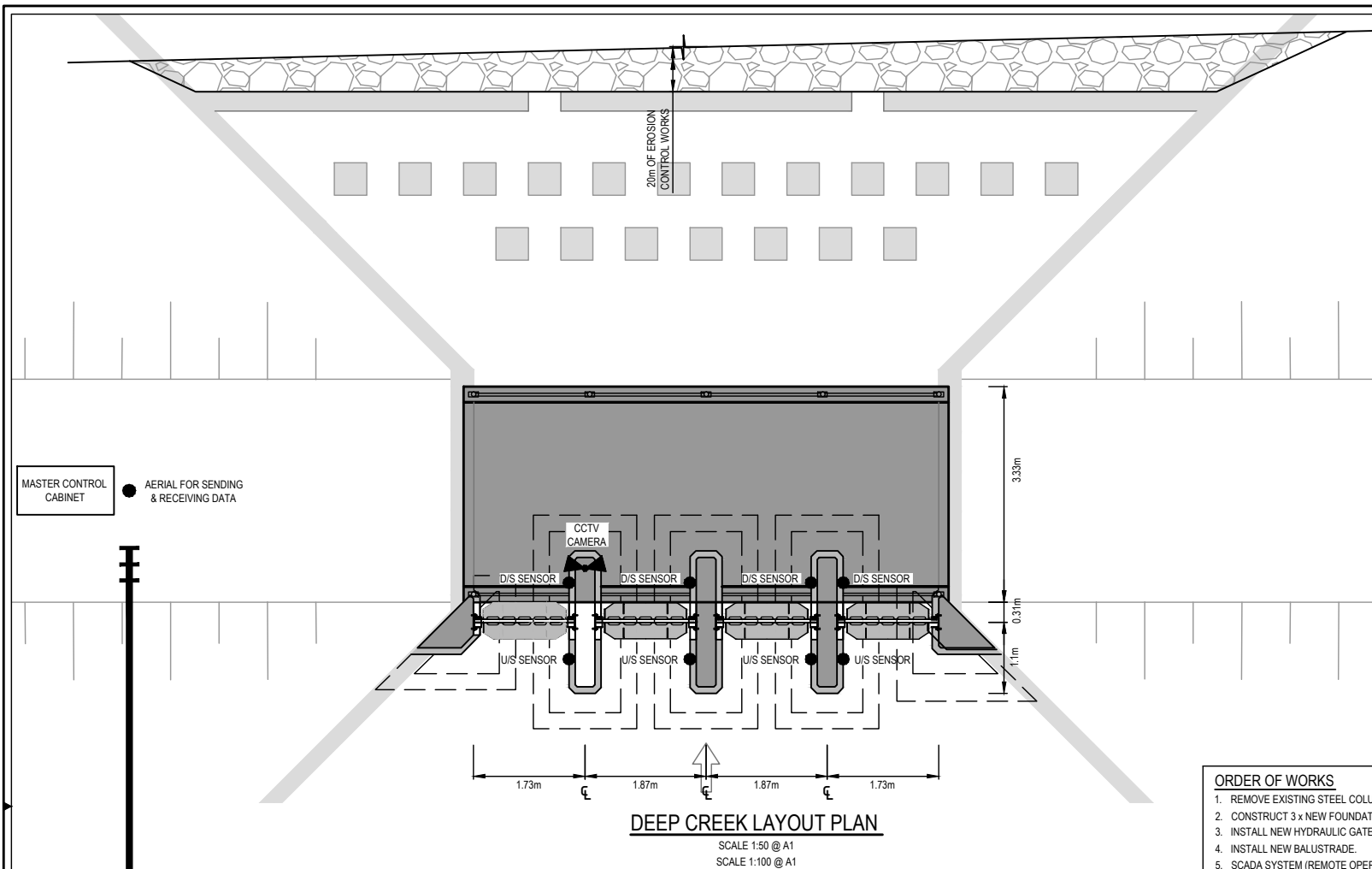

- ORDER OF WORKS**
1. REMOVE EXISTING STEEL COLUMNS, HANDRAIL & TIMBER DROP BOARDS.
  2. CONSTRUCT 3 x NEW FOUNDATIONS & SHEER WALLS.
  3. INSTALL NEW HYDRAULIC GATES.
  4. INSTALL NEW BALUSTRADE.
  5. SCADA SYSTEM (REMOTE OPERATION & COMMUNICATIONS).
  6. REMOVE TREES UP STREAM OF STRUCTURE.
  7. PLACE ROCK BEACHING ON DOWN STREAM SIDE OF STRUCTURE.
- NOTES!**
1. ALL LEVELS & DIMENSIONS TO BE CONFIRMED ONSITE BY MANUFACTURER.
  2. TOP OF GATES AT 55,000 ML PER DAY (DEEP CREEK 105.31m).

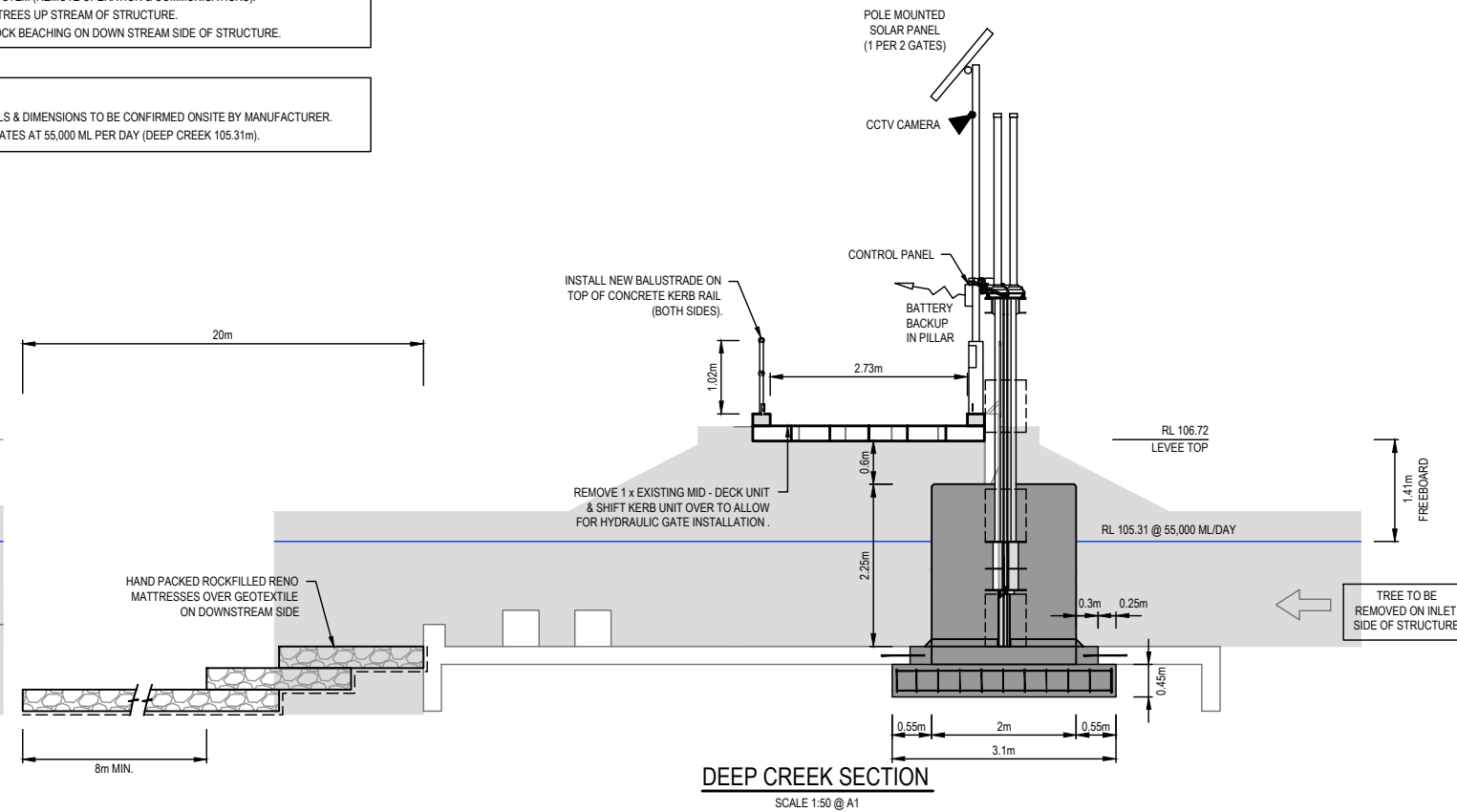
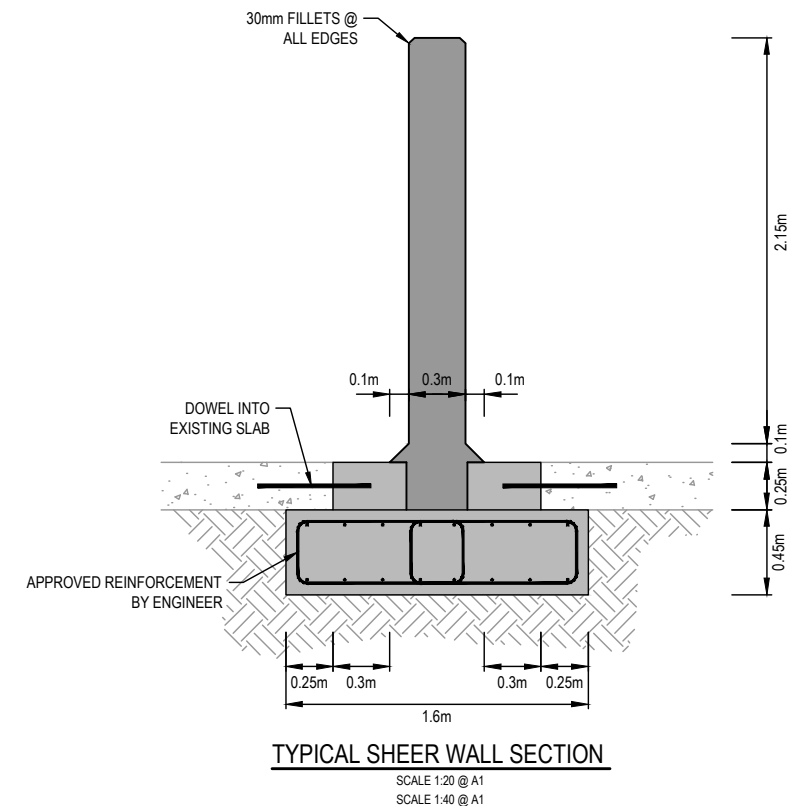

© GMR Engineering Services  
UNAUTHORISED USE IS STRICTLY PROHIBITED. ALL INFORMATION IS FOR INFORMATION ONLY AND SHOULD NOT BE USED FOR ANY OTHER PURPOSE WITHOUT THE WRITTEN PERMISSION OF GMR ENGINEERING SERVICES. DIMENSIONS NOT TO BE SCALED.

**GMR**  
Engineering Services  
Phone: (03) 5822 0333  
Fax: (03) 5822 0033  
Website: gmreng.com.au

**WARNING**  
BEWARE OF UNDERGROUND SERVICES  
The locations of underground services are approximate only and their exact position should be proven on site. No guarantee is given that all existing services are shown.

**NOTE !**  
BEWARE OF EXISTING OVERHEAD POWER CABLES.

**PRELIMINARY**  
(NOT FOR CONSTRUCTION)  
20/10/2015

REDUCED SCALE

**GOULBURN BROKEN**  
CATCHMENT MANAGEMENT AUTHORITY

DESIGNED	G. Ryan	September 2015
DRAFTED	R. Barker	September 2015
VERIFIED	C. S. Jajal	October 2015
2	GMR MARKUPS	25-09-15
1	ADOPTED 300mm FREEBOARD FROM LEVEE TOP	25-09-15
A	INITIAL DRAFT	18-09-15
REV	AMENDMENTS	DATE

0 0.5 1 2.0m  
SCALE 1:50 @ A1  
SCALE 1:100 @ A3

**N**

**GMR Engineering Services**  
Goulburn Broken Catchment Management Authority  
Lower Goulburn Structure Evaluation  
Pogues Road, Bunbartha

**Works Arrangements - Deep Creek Outlet**  
Drawing No. GMR15013.09  
Revision. 2  
GMR15013.04 proposed works.dwg

Sheet No. 9

